

REV	DESCRIPTION	DATE
△	RDK-97127	謝婉如 2008/09/16
△	RDK-98020	張馨尹 2009/09/02
△	RDC-99213	張馨尹 2010/05/28

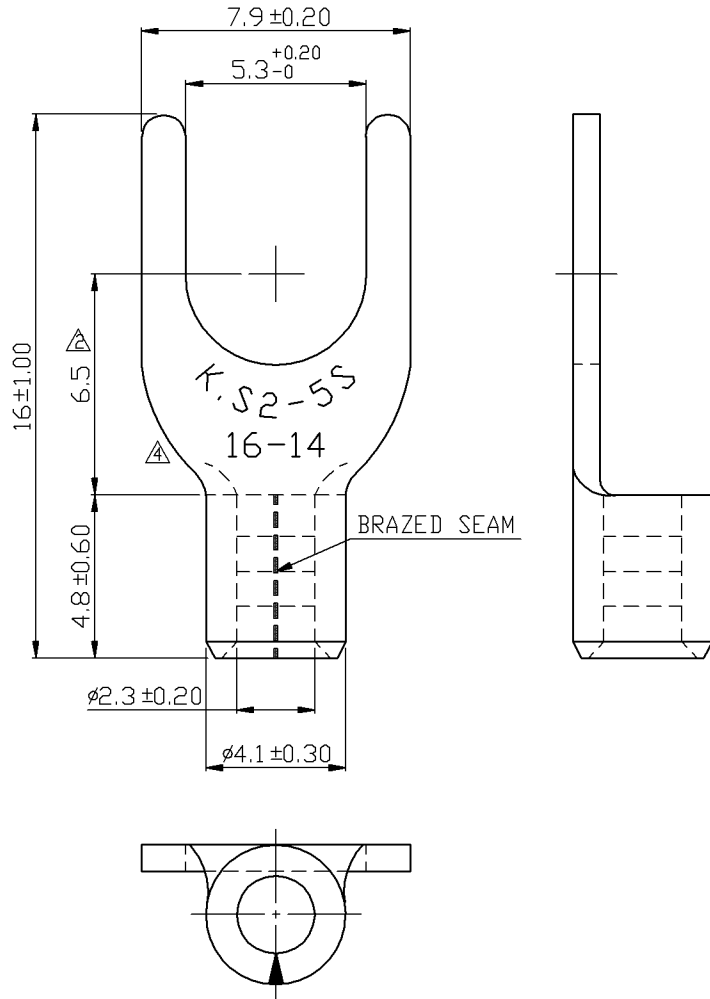

- NOTE :
- MAXIMUM ELECTRIC CURRENT :

A.W.G.	16	14		
AMP.	18	30		
 - WIRE RANGE : 16-14 A.W.G. (1.5-2.5 mm²)
 - SURFACE TREATMENT : TIN PLATED
 - THICKNESS : 0.80 mm

Tolerance Unless Otherwise Specified	
0 >	mm ± ANGLE
>	mm ± 0° ° REF ±
>	mm ± ° ° ±
>	mm ± ° ° ±

NAME	NON-INSULATED SPADE TERMINALS				UNIT	mm	
PART NO.	SNBS2-5	MATERIAL	COPPER	APPROVE			
NUMBER	KT-94449-C	SCALE	SHEET	PAGE	CHECKED		
DATE	2008/01/25	5/1	1-4	10F2	DRAWN	張馨尹	

KST. K.S. TERMINALS INC.